



RANGE OF PROCESSING WORK PIECES THICKNESS

THICKNESS (t)	0.5	0.6	0.8	1	1.2	1.4	1.6	2	2.3	2.6	3	3.2	3.6	4	4.5	5	6	7	8	9	10										
WB (P) 120 (0.3~1.2)	V4		V6		V7																										
	V8			V10			V12			V14																					
	V16				V18				V20																						
WB (P) 230 (0.3~2.3)	V25					V32																									
	V40						V50																								
WB (P) 350 (0.5~3.5)	V63							V80																							
	V90																														

Accessory / Adapter

Rail & Pleate (WB001)

Model No.	Rail Length (mm)	Weight (kg)
WB001-415	415	6
WB001-835	835	12.1

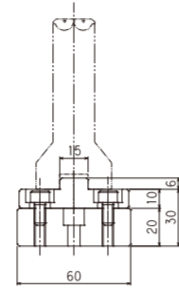

Centering Jig (WB002)

Model No.	Jig Height (mm)	Weight (kg)
WB002-85	85	1.2

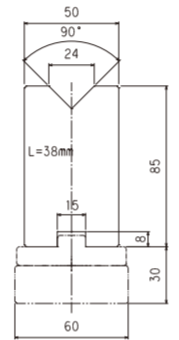

Fit bar (WB003C)

Model No.	Length (mm)	Weight (kg)
WB003C-200	196	0.6
WB003C-100	98	0.3
WB003C-50	48	0.2
WB003C-30	28	0.1
WB003C-25	23	0.1
WB003C-20	18	0.1
WB003C-15	13	0.1

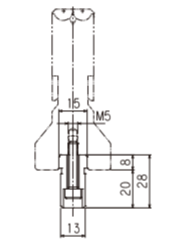

Slider (SLP120/230/350/650S/650)

※WBP950 uses a part of WBP650.

Slider available for all types of WING BEND Plus products.
The kind of length will be the following.
50mm/100~1000mm(Every 100mm)/
1000~3000mm(Every 500mm)

Please read very carefully bundled "Operator's manual" for the proper and safety usage of Wing Bend & Wing Bend Plus dies.

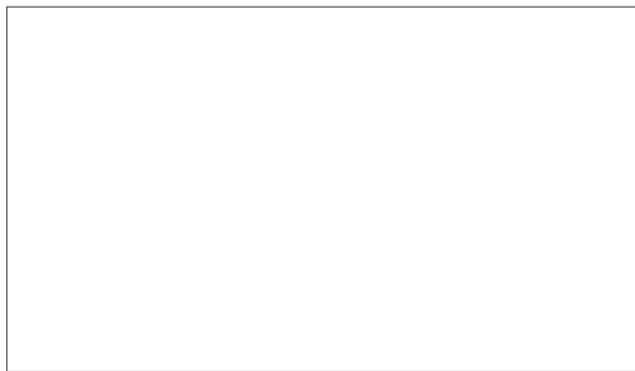

[Publisher]
TSH International, Inc.
134 Higashikata-Cho, Tsuzuki-Ku, Yokohama-City,
Kanagawa-Pref., Post-Code 224-0045 JAPAN
TEL: +81-45-507-4545 FAX: +81-45-624-9840
URL <http://www.wingbend.com>

[Manufacturer]
TOKYO SEIMITSU HATSUJO Co., Ltd.
134 Higashikata-Cho, Tsuzuki-Ku, Yokohama-City,
Kanagawa-Pref., Post-Code 224-0045 JAPAN
TEL: +81-45-624-9841 FAX: +81-45-624-9840
URL <http://www.to-hatsu.co.jp>

2018.10.01



WING BEND
WING BEND *Plus*

Amazing and Perfect mark free processing changing the common sense of the sheet metal industry.

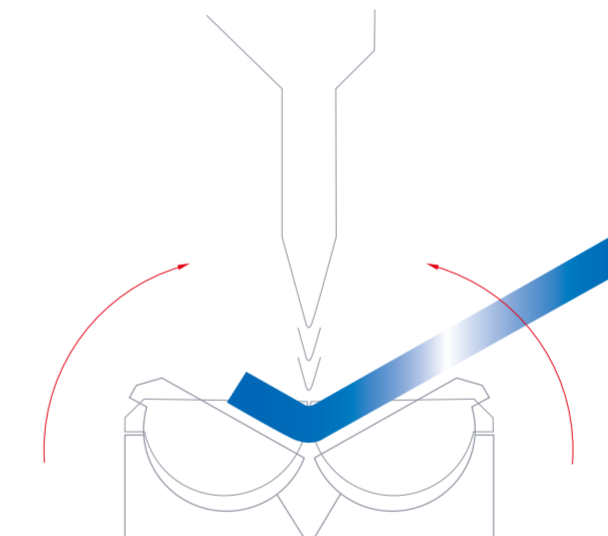

WING BEND

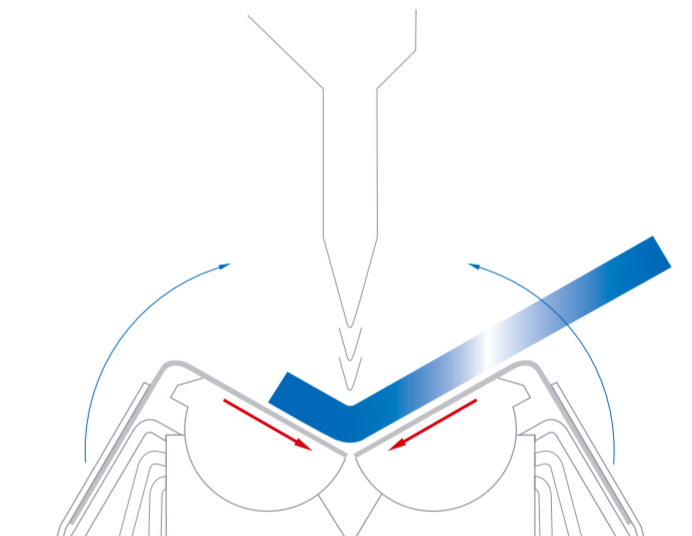

WING BEND *Plus*



Amazing and Perfect mark free processing changing the common sense of the sheet metal industry.

WING BEND

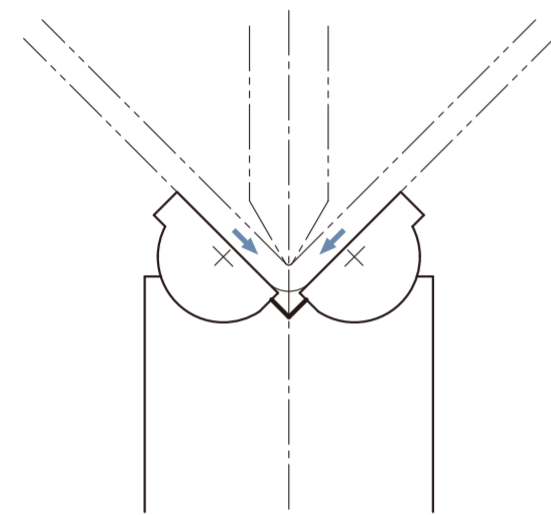

Feature of Wing Bend

- Mark free
- Distortion-free near hole
- Swelling-less for oblique bending
- Exceptional short-flange bending
- Wide range of bending thickness
- Decreasing time loss of dies exchange
- Wide bending angle like obtuse angle, right angle and acute angle
- High precision bending
- The die's expense is reduced
- Workers can learn a sheet metal technology in a short time



WING BEND Plus

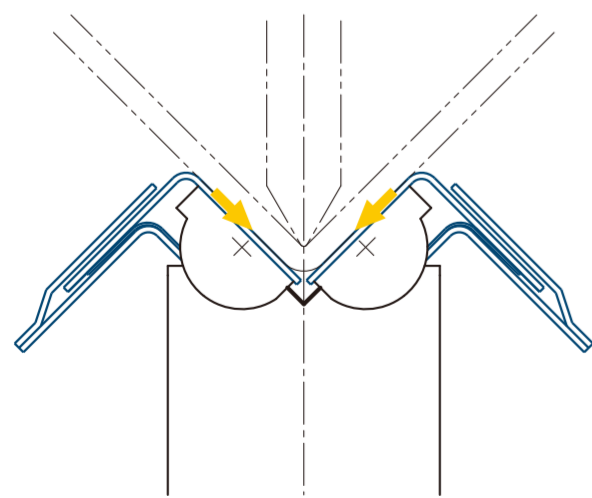

Wing Bend Plus is full version of Wing bend

- Realization the perfect mark free and high accuracy· high quality bending of beautiful outside radius without a trace that was not possible in the Wing Bend while leaving the good Wing Bend.
- We improved durability performance by implementing slider.
- Wing Bend Plus is the most suitable for stainless steel bending in disfavor with bending mark and defect.



WING BEND - Specifications

WB120

Supported workpiece thickness (mm) 0.3~1.2
Resist pressure (kN/m) 500

Model No.	Mold Length (mm)	Weight (kg)
WB120-50	50	0.5
WB120-100	100	1
WB120-200	200	2.1
WB120-90SET	30/25/20/15	1.1

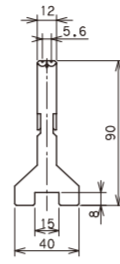

WB230

Supported workpiece thickness (mm) 0.3~2.3
Resist pressure (kN/m) 700

Model No.	Mold Length (mm)	Weight (kg)
WB230-50	50	0.8
WB230-100	100	1.7
WB230-200	200	3.2
WB230-90SET	30/25/20/15	1.5

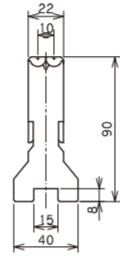

WB350

Supported workpiece thickness (mm) 0.5~3.2
Resist pressure (kN/m) 1000

Model No.	Mold Length (mm)	Weight (kg)
WB350-50	50	1
WB350-100	100	1.9
WB350-200	200	3.9

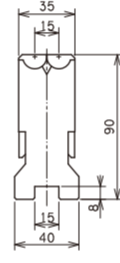

WB650S

Supported workpiece thickness (mm) 0.5~6.5
Resist pressure (kN/m) 1500

Model No.	Mold Length (mm)	Weight (kg)
WB650S-50	50	1.8
WB650S-100	100	3.5
WB650S-200	200	7

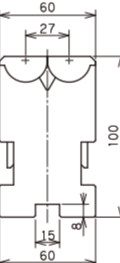

WB650

Supported workpiece thickness (mm) 1.2~6.5
Resist pressure (kN/m) 1500

Model No.	Mold Length (mm)	Weight (kg)
WB650-50	50	2.6
WB650-100	100	5.6
WB650-200	200	11

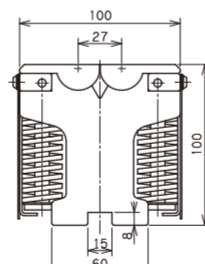

WB950

Supported workpiece thickness (mm) 6.5~9.5
Resist pressure (kN/m) 2000

Model No.	Mold Length (mm)	Weight (kg)
WB950-100	100	6.6
WB950-200	200	13.3

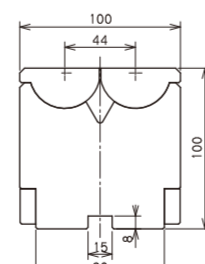

WING BEND Plus - Specifications

WBP120

Supported workpiece thickness (mm) 0.3~1.2
Resist pressure (kN/m) 500

Model No.	Mold Length (mm)	Weight (kg)
WBP120-50	50	0.5
WBP120-100	100	1
WBP120-200	200	2
WBP120-500	500	5
WBP120-90SET	30/25/20/15	1.1

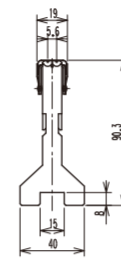

WBP230

Supported workpiece thickness (mm) 0.3~2.3
Resist pressure (kN/m) 700

Model No.	Mold Length (mm)	Weight (kg)
WBP230-50	50	0.8
WBP230-100	100	1.6
WBP230-200	200	3.2
WBP230-500	500	8
WBP230-90SET	30/25/20/15	1.5

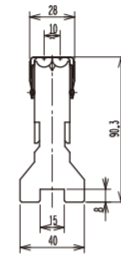

WBP350

Supported workpiece thickness (mm) 0.5~3.2
Resist pressure (kN/m) 1000

Model No.	Mold Length (mm)	Weight (kg)
WBP350-50	50	0.9
WBP350-100	100	1.9
WBP350-200	200	3.8
WBP350-500	500	9.5

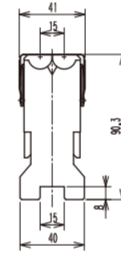

WBP650S

Supported workpiece thickness (mm) 0.5~6.5
Resist pressure (kN/m) 1500

Model No.	Mold Length (mm)	Weight (kg)
WBP650S-50	50	1.8
WBP650S-100	100	3.5
WBP650S-200	200	7
WBP650S-500	500	17.5



WBP650

Supported workpiece thickness (mm) 1.2~6.5
Resist pressure (kN/m) 1500

Model No.	Mold Length (mm)	Weight (kg)
WBP650-50	50	2.6
WBP650-100	100	5.6
WBP650-200	200	11

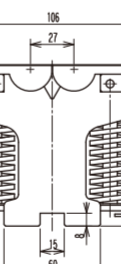

WBP950

Supported workpiece thickness (mm) 6.5~9.5
Resist pressure (kN/m) 2000

Model No.	Mold Length (mm)	Weight (kg)
WBP950-100	100	6.6
WBP950-200	200	13.3

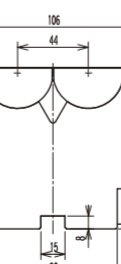

A Type ~ AMADA 1V HOLDER

WING BEND - Specifications

WB120A

Supported workpiece thickness (mm) 0.3~1.2
Resist pressure (kN/m) 500

Model No.	Mold Length (mm)	Weight (kg)
WB120A-50	50	0.4
WB120A-100	100	0.7
WB120A-200	200	1.4
WB120A-500	500	2.8
WB120A-90SET	30/25/20/15	0.6

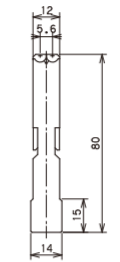

WB230A

Supported workpiece thickness (mm) 0.3~2.3
Resist pressure (kN/m) 700

Model No.	Mold Length (mm)	Weight (kg)
WB230A-50	50	0.6
WB230A-100	100	1.2
WB230A-200	200	2.3
WB230A-500	500	4.7
WB230A-90SET	30/25/20/15	1.1

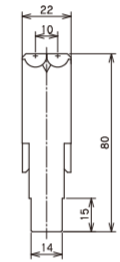

WB350A

Supported workpiece thickness (mm) 0.5~3.5
Resist pressure (kN/m) 1000

Model No.	Mold Length (mm)	Weight (kg)
WB350A-50	50	0.8
WB350A-100	100	1.5
WB350A-200	200	3
WB350A-500	500	6.9

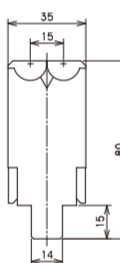

WB650SA

Supported workpiece thickness (mm) 0.5~6.5
Resist pressure (kN/m) 1500

Model No.	Mold Length (mm)	Weight (kg)
WB650SA-50	50	1.3
WB650SA-100	100	2.6
WB650SA-200	200	5.2
WB650SA-500	500	12.9

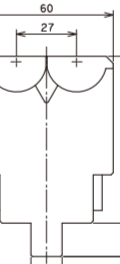

WING BEND Plus - Specifications

WBP120A

Supported workpiece thickness (mm) 0.3~1.2
Resist pressure (kN/m) 500

Model No.	Mold Length (mm)	Weight (kg)
WBP120A-50	50	0.5
WBP120A-100	100	0.9
WBP120A-200	200	1.7
WBP120A-500	500	3.6
WBP120A-90SET	30/25/20/15	0.8

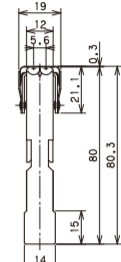

WBP230A

Supported workpiece thickness (mm) 0.3~2.3
Resist pressure (kN/m) 700

Model No.	Mold Length (mm)	Weight (kg)
WBP230A-50	50	0.7
WBP230A-100	100	1.3
WBP230A-200	200	2.6
WBP230A-500	500	5.4
WBP230A-90SET	30/25/20/15	1.2

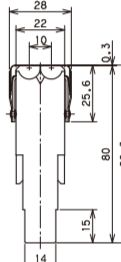

WBP350A

Supported workpiece thickness (mm) 0.5~3.5
Resist pressure (kN/m) 1000

Model No.	Mold Length (mm)	Weight (kg)
WBP350A-50	50	0.9
WBP350A-100	100	1.7
WBP350A-200	200	3.3
WBP350A-500	500	7.7

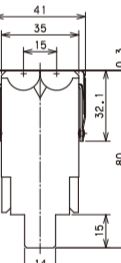

WBP650SA

Supported workpiece thickness (mm) 0.5~6.5
Resist pressure (kN/m) 1500

Model No.	Mold Length (mm)	Weight (kg)
WBP650SA-50	50	1.4
WBP650SA-100	100	2.8
WBP650SA-200	200	5.5
WBP650SA-500	500	13.7

